

## Encompass Series Battery Pack

### Battery Pack User's Manual

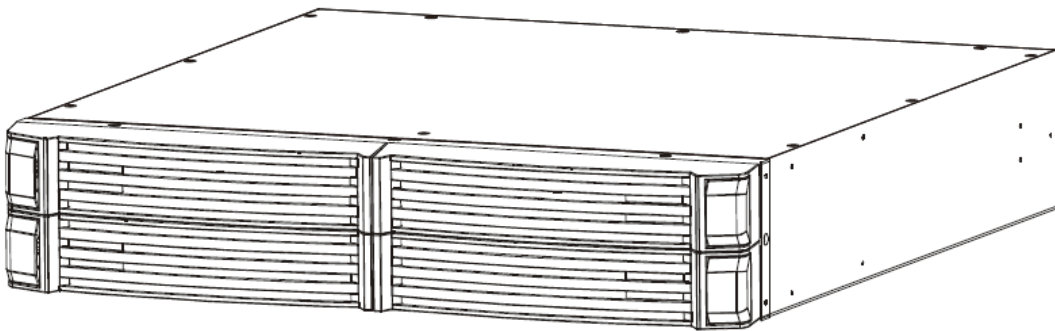



## Table of Contents

Introduction	1
1. Important Safety Warning	2
2. Installation and setup	5
3. Operations	9
4. Obtaining Service	10
5. Replacing the Batteries	11
6. Specifications	13
7. Warranty	14
A1 Declaration of Conformity	16

# Introduction

Thank you for purchasing a MINUTEMAN power protection product. It has been designed and manufactured to provide many years of trouble-free service.

**SAVE THESE INSTRUCTIONS** - This manual contains important instructions that should be followed during the installation and the maintenance of the Battery Pack.

**IMPORTANT SAFETY INSTRUCTIONS**  
**SAVE THESE INSTRUCTIONS!**  
**CONSIGNES DE SÉCURITÉ IMPORTANTES**  
**SAUVEGARDEZ CES CONSIGNES!**

Please read this manual and comply with all warnings and instructions before installing your Encompass Series Battery Pack as it provides important information that should be followed during its installation and maintenance, allowing you to correctly set up your UPS for the maximum safety and performance. Included is information on customer support and factory service, if it is required. If you experience a problem with the UPS system please refer to the Troubleshooting guide in this manual to correct the problem or collect enough information so that the Technical Support Department can assist you.

*Veillez lire ce manuel et vous conformer à tous les avertissements et instructions avant d'installer votre batterie de la série Encompass, car il fournit des informations importantes qui doivent être suivies lors de son installation et de sa maintenance, vous permettant de configurer correctement votre UPS pour une sécurité et des performances maximales. Des informations sur le support client et le service d'usine sont incluses, si nécessaire. Si vous rencontrez un problème avec le système UPS, veuillez vous référer au guide de dépannage de ce manuel pour corriger le problème ou collecter suffisamment d'informations pour que le service d'assistance technique puisse vous aider.*

Batteries can present a risk of electrical shock. Observe proper cautions and do not bridge the battery terminals at any time. Follow all precautions and instructions for battery replacement and disposal in the BATTERY REPLACEMENT section of this manual.

*Les batteries peuvent présenter un risque de choc électrique. Observez les précautions appropriées et ne pontez à aucun moment les bornes de la batterie. Suivez toutes les précautions et instructions pour le remplacement et la mise au rebut de la batterie dans la section REMPLACEMENT DE LA BATTERIE de ce manuel.*

# 1. Important Safety Warnings

**CAUTION!** - This Battery Pack series is ONLY intended to be installed in an indoor temperature-controlled environment that is free of conductive contaminants.

**CAUTION!** - The maximum ambient operating temperature for this Battery Pack series is 40°C ("0 ~ 40°C" for Ambient Operation).

- The external vents and openings on the Battery Pack are provided for ventilation. To ensure reliable operation of the Battery Pack and to protect the Battery Pack from overheating, these vents and openings must not be blocked or covered. Do not insert any object into any of the vents or opening that may hinder the ventilation.
- Install the Battery Pack in a well-ventilated area, away from excess moisture, heat, dust, flammable gas or explosives.
- Leave adequate space (at least 20cm) in the front and at the rear of the Battery Pack for proper ventilation.
- Do not mount the Battery Pack with its front or rear panel facing down at any angle.
- Before usage, you must allow the Battery Pack to adjust to room temperature (20°C~25°C or 68°F~77°F) for at least one hour to avoid moisture condensing inside the Battery Pack.

**WARNING!** - This Battery Pack contains potentially hazardous voltages. Do not attempt to disassemble the Battery Pack beyond the battery replacement procedure. This Battery Pack contains no user serviceable parts. Repairs and Battery replacement must be performed by **QUALIFIED SERVICE PERSONNEL ONLY**.

**WARNING! - Qualified Service Personnel ONLY** must perform the Installation and Servicing of these Battery Packs. MINUTEMAN accepts no liabilities and is not limited to: injury to the Service Personnel, or damages to; the Battery Pack and the UPS, or the connected equipment caused by the incorrect installation or servicing of the Battery Pack.

**WARNING!** - Risk of Electrical Shock. Hazardous live parts inside these power supplies are energized from the battery even when disconnected from the UPS.

**CAUTION! - DO NOT USE THE MOUNTING BRACKETS TO LIFT THE BATTERY PACK.** The mounting brackets are ONLY for securing the Battery Pack to the rack.

**NOTE:** These Battery Packs are shipped with the internal batteries connected. It is not necessary to open the unit to install.

**CAUTION!** - To de-energize the Battery Pack:

1. If a connected UPS is on, press and then release the OFF button after the audible alarm beeps twice to turn the UPS off.
2. Disconnect the Battery Pack from the UPS.
3. Open the DC Breaker on the back panel of the battery pack
4. Disconnect the battery modules

**NOTICE:** This equipment has been tested and found to comply with the limits for a Class A and/or B computing device in accordance with the specifications in Subpart J of Part 15 of FCC Rules and the Class A and/or B limits for radio noise emissions from digital apparatus set out in the Radio Interference of the Canadian Department of Communications. These limits are designed to provide reasonable protection against such interference in a residential installation. This equipment generates and uses radio frequency and if not installed and used properly, that is, in strict accordance with the manufacturer's instructions, this equipment may cause interference to radio and television reception. If this equipment does cause interference to radio or television reception, which can be determined by turning the equipment off and on, the user is encouraged to try to correct the interference by one or more of the following measures:

- Re-orient the receiving antenna.
- Relocate the computer with respect to the receiver.
- Move the computer away from the receiver.
- Plug the computer into a different outlet so that the computer and receiver are on different branch circuits.
- Shielded communications interface cables must be used with this product.

**WARNING:**

Changes or modifications to this unit not expressly approved by the party responsible for compliance could void the user's authority to operate the equipment.

**Receiving Inspection**

After removing your Battery Pack from its carton, it should be inspected for damage that may have occurred in shipping. Immediately notify the carrier and place of purchase if any damage is found. Warranty claims for damage caused by the carrier will not be honored. The packing materials that your Battery Pack was shipped in are carefully designed to minimize any shipping damage. In the unlikely case that the Battery Pack needs to be returned to the manufacturer, please use the original packing material. Since the manufacturer is not responsible for shipping damage incurred when the system is returned, the original packing material is inexpensive insurance. **PLEASE SAVE THE PACKING MATERIALS!**

### Life Support Policy

As a general policy, we do not recommend the use of any of our products in life support applications where failure or malfunction of the product can be reasonably expected to cause failure of the life support device or to significantly affect its safety or effectiveness. We do not recommend the use of any of our products in direct patient care. We will not knowingly sell our products for use in such applications unless it receives in writing assurances satisfactory to us that (a) the risks of injury or damage have been minimized, (b) the customer assumes all such risks, and (c) our liability is adequately protected under the circumstances.

**WARNING!** - Qualified Service Personnel ONLY must perform the Installation and Servicing of these Battery Packs. MINUTEMAN accepts no liabilities and is not limited to: injury to the Service Personnel, or damages to: the Battery Pack, the UPS, or the connected equipment caused by the incorrect installation or servicing of the Battery Packs. These Battery Packs MUST be operated with their respective UPS models, see the table below:

Battery Pack	BP24RTXL2U	BP48RTXL2U	BP72RTXL2U
UPS	EC1000RTXL2U	EC1500RTXL2U EC2000RTXL2U	EC3000RTXL2U

**© COPYRIGHT 2024 BY PARA SYSTEMS, INC.**

All Rights Reserved. All rights of this User's Manual ("Manual"), including but not limited to the content, information, and figures are solely owned and reserved by Para Systems, Inc. ("Para Systems"). The Manual can only be applied to the operation or the use of this product. Any disposition, duplication, dissemination, reproduction, modification, translation, extraction, or usage of this Manual in whole or in part is prohibited without the prior written permission of Para Systems. Given that Para Systems will continuously improve and develop the product, changes may be made to the information in this Manual at any time without obligation to notify any person of such revision or changes. Para Systems will make all possible efforts to secure the accuracy and the integrity of this Manual. Para Systems disclaims any kinds or forms of warranty, guarantee, or undertaking, either expressly or implicitly, including but not limited to the completeness, faultlessness, accuracy, non- infringement, merchantability or fitness for a particular purpose of the Manual.

## 2. Installation and Setup

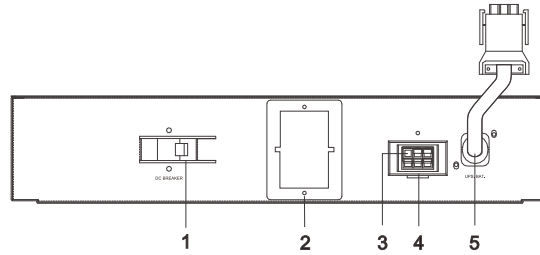

1. DC Breaker (Option)	1. Battery Over-current Protection. 2. Easily remove battery bank from system.
2. DC Fuse(s)	Battery Over-current Protection.
3. Earth Terminal	For safety grounding connection.
4. Battery Connector	Battery bank extending connector.
5. DC Power Cord	To link with UPS and battery banks.

This Battery Pack series is **ONLY** intended to be installed in an indoor temperature-controlled environment that is free of conductive contaminants. DO NOT operate the Battery Pack in extremely dusty and/or unclean areas, locations near heating devices, water or excessive humidity, or where the Battery Pack is exposed to direct sunlight. Select a location, which will provide good air circulation for the Battery Pack at all times. Route any cords so they cannot be walked on or damaged. Typical battery life is 3 to 5 years. Environmental factors do affect battery life. High temperatures, poor utility power, and frequent, short duration discharges have a negative impact on battery life.

### ENVIRONMENTAL CONDITIONS

- Operating Temperature (Max.): 0° to 40°C (+32° to +104°F)
- Storage Temperature: -15° to +45°C (+5° to +113°F)
- Operating/ Storage Humidity: 10% to 90%, non-condensing
- Operating Elevation: 0 to 3,000m (0 to +10,000 ft)
- Storage Elevation: 0 to 15,000m (0 to +50,000 ft)

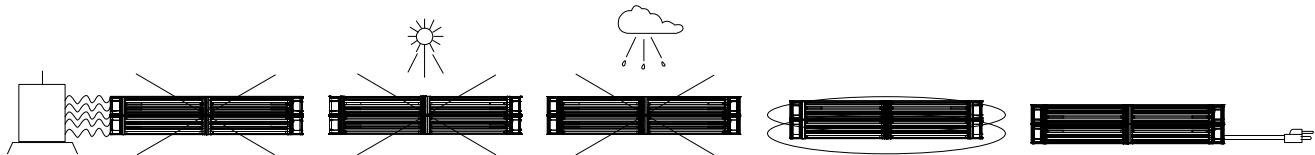

### INSTALLATION

Be sure to read the installation placement and all the cautions before installing the Battery Pack. Place the Battery Pack in the final desired location and complete the rest of the installation procedure. These Battery Packs are shipped with the internal batteries connected. See the "Rackmount Configuration" to install the Battery Pack into the rack. **USE CAUTION:** The Battery Pack is heavy. Use the appropriate number of personnel when installing.



**CAUTION! - DO NOT USE THE MOUNTING BRACKETS TO LIFT THE UPS.**

The mounting brackets are **ONLY** for securing the Battery Pack to the rack.

**RACKMOUNT CONFIGURATION**

This Battery Pack series comes with mounting brackets for the standard 19" (46.5cm) rack pre-installed on the Battery Pack. The Rail Kits for 4-post racks and cabinets are also available. The screws for mounting the Battery Pack to the rack are included.

**CAUTION! DO NOT USE THE MOUNTING BRACKETS TO LIFT THE BATTERY PACK.** The mounting brackets are **ONLY** for securing the Battery Pack to the rack.

**NOTE:** The mounting brackets can be mounted in the middle of the Battery Pack.

1. Remove the Battery Pack from the shipping box.
2. Mount the Battery Pack into the rack and secure with the retaining screws. **WARNING:** Use two or more people when installing the Battery Pack. Use **CAUTION**, the Battery Pack is extremely heavy. Do not move the rack after the units have been installed. The rack may become unstable due to the weight distribution.
3. The Rackmount Configuration is complete. See Connecting the Battery Pack.

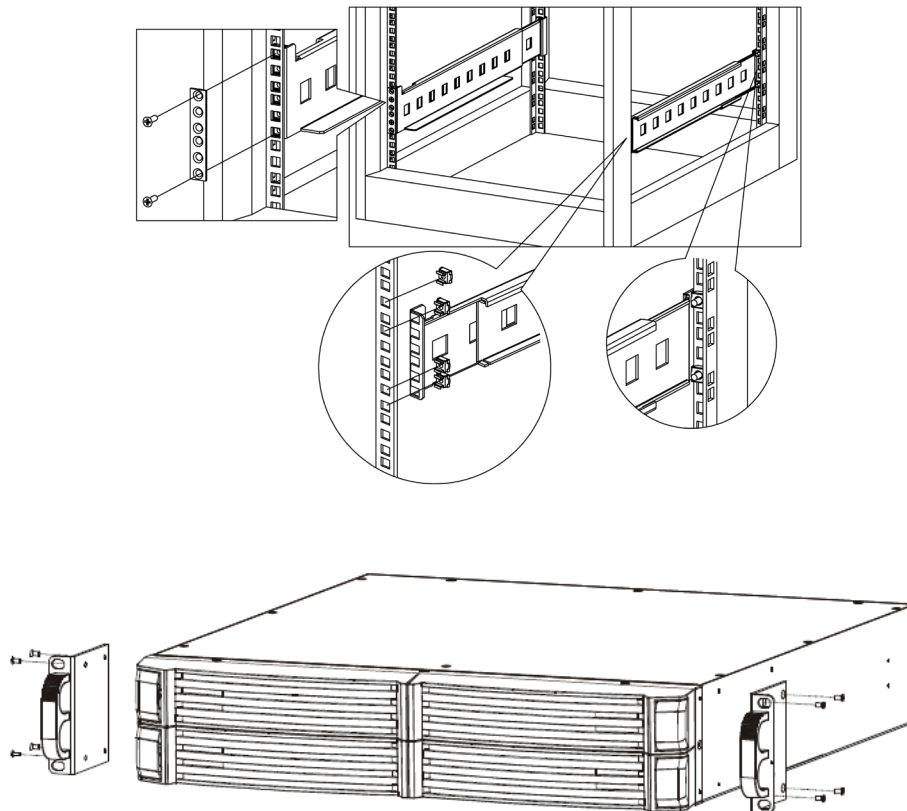

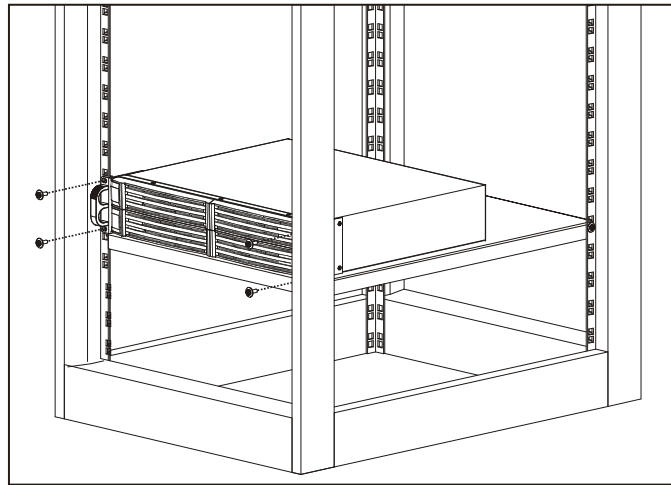

### **TOWER CONFIGURATION**

The tower configuration allows the user to install the Battery Pack in the upright position next to the UPS and the tower computer. The tower brackets are provided with the Battery Pack.

**WARNING!** - Use two or more people when installing the Battery Pack. Use **CAUTION**, the Battery Pack is extremely heavy.

1. Once the location of the Battery Pack has been determined, place the tower brackets in the desired location.

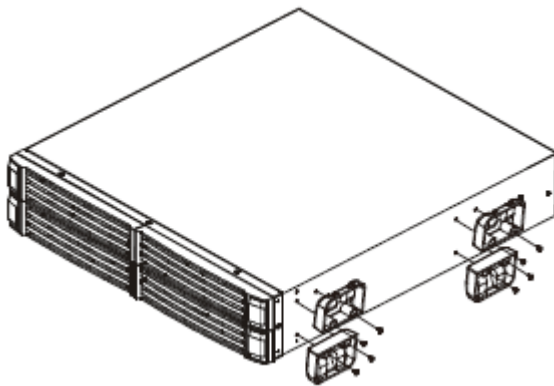

**FIG. 1**

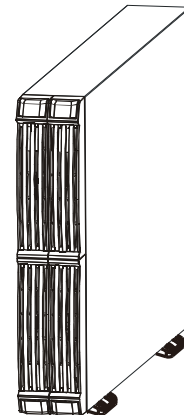

**FIG. 2**

**WARNING:** The Battery Pack must be installed in the proper up-right position. If the Battery Pack is not installed in the proper up-right position the Batteries will be damaged. Once the Battery Pack is placed in the tower brackets, looking at the front panel of the Battery Pack the top cover of the Battery Pack **MUST** be on your left-hand side.

2. Use the included screws to attach the tower feet to the left-hand side of the case when lying horizontally, (FIG. 1).
3. Tilt the cabinet into upright position. The Tower Configuration is now complete. See Connecting the Battery Pack.

## CONNECTING THE BATTERY PACK

**NOTE:** When attaching the Battery Packs, the UPS must be configured so that it will report the correct estimated runtime on the LCD screen and in the Power Monitoring software and/or the SNMP card. See the Power Monitoring software or the SNMP card's User's Manual to configure the UPS.

1. Make sure that the DC breaker on the rear panel of the Battery Pack is in the Open position.
2. Turn the UPS off and disconnect the UPS's input power cord from the AC wall outlet.
3. Remove the External Battery Connector cover plate from the UPS's rear panel, (if necessary).
4. Verify, before connecting the Battery Pack's external battery cable into the UPS's external battery connector, that they mate red to red and black to black. **NOTE:** The red connector is the battery positive (+) and the black connector is the battery negative (-). Connect the external battery cable from the Battery Pack to the external battery connector on the UPS. **NOTE:** If connecting more than one Battery Pack see **"Daisy Chaining"**.

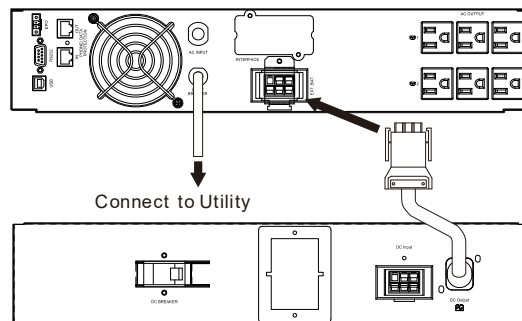

## DAISY CHAINING

(QUALIFIED SERVICE PERSONNEL ONLY)

"Daisy Chaining" means connecting one battery pack to another battery pack to another battery pack, this chain could go on indefinitely. Follow the steps below to daisy chain the battery packs:

1. Be sure to read the installation placement procedure, all of the cautions and the safety precautions before daisy chaining the battery pack(s).
2. Make sure that all the battery pack's DC breakers and UPS are turned off. **CAUTION:** If the battery pack's DC breaker is in the on position, the battery voltage will be present at the open end of the battery pack's external battery cable and external battery connector. Unplug all the equipment that is plugged into the UPS output receptacles. Disconnect the UPS power cord from the AC wall outlet.
3. Remove the External Battery Connector's cover plate from the UPS rear panel and the additional Battery Packs.
4. Verify, before plugging the external battery cable into the UPS external battery connector or the battery pack's external connector that they mate red to red and black to black.
5. Connect the external battery cable from the first battery pack to the external battery connector on the UPS.
6. Connect the external battery cable from the second battery pack to the external battery connector on the first battery pack.
7. Turn ALL of the DC breakers on the rear panel of the battery packs to the on position.

8. The battery packs are ready for normal operation, see the UPS User's Manual for the normal startup of the UPS.

**NOTE:** The maximum number that can be daisy chained is ten battery packs.

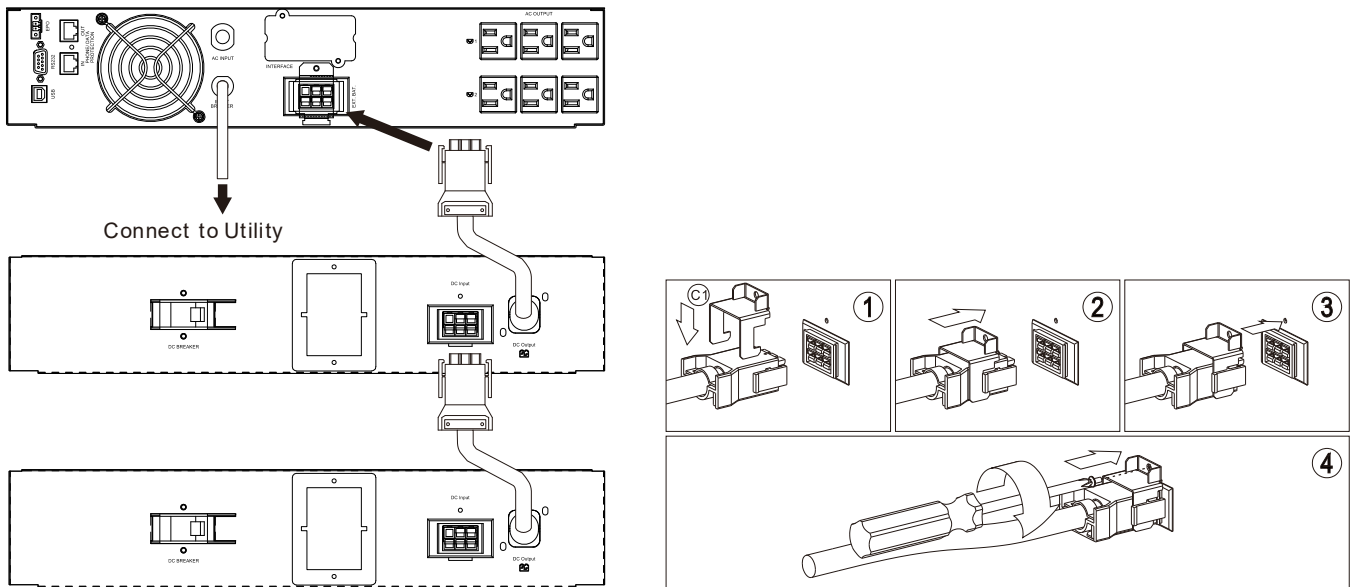

## 3. Operations

### SYSTEM OVERVIEW

The Battery Pack will extend the runtime capabilities of the UPS. When the commercial power is lost, the charger will turn off and the battery pack(s) will extend the runtime of the UPS. When the commercial power returns the battery pack(s) will automatically start recharging the batteries if connected to the UPS. During normal AC operation, the UPS and battery pack will quietly and confidently protect your system from power anomalies.

### TURNING THE BATTERY PACK ON/OFF

Turning the DC breaker to the On position will connect the DC bus voltage from the battery pack to the UPS. Turning the DC breaker to the Off position will disconnect the DC bus voltage from the battery pack to the UPS.

## 4. Obtaining Service

### **IF THE BATTERY PACK REQUIRES SERVICE**

1. Verify there are no tripped circuit breakers and that the batteries are good. A tripped circuit breaker and defective batteries are the most common issues.
2. Call your dealer for assistance. If you cannot reach your dealer, or if they cannot resolve the issue call Minuteman's Technical Support department at (972) 446-7363 or visit our website at <https://minutemanups.com/contact/>. Before calling the Technical Support Department have the following information available:
  - a) Contact name and address.
  - b) Where and when the unit was purchased.
  - c) All of the model information about your unit.
  - d) The serial number of your unit.
  - e) Any additional information on the failure.
  - f) A description of the protected equipment including model numbers, if possible.
  - g) A technician will ask you for the above information and if possible, help solve the issue over the phone. In the event that the unit requires factory service, the Technical Support Representative will issue you a Return Material Authorization Number (RMA #).

**NOTE: We must have the model number and the serial number of the product to issue an RMA #.**

- h) If the unit is under warranty, the repairs will be done at no charge. If the unit is not under warranty there will be a charge for the repair.
- 3. Pack the unit in its original packaging. If the original packaging is no longer available, ask the Technical Support Representative about obtaining a new set. It is important to pack the unit properly in order to avoid damage in transit. Never use Styrofoam beads for a packing material.
  - a) Include a letter with your name, address, daytime phone number, RMA number, a copy of your original sales receipt, and a brief description of the problem.
- 4. Mark the RMA # on the outside of all packages. The factory cannot accept any package without the RMA # marked on the outside.
- 5. Return the unit by insured, prepaid carrier to:

Para Systems, Inc.  
MINUTEMAN UPS  
2425 Technical Road  
Miamisburg, OH 45342  
ATTN: RMA # \_\_\_\_\_

# 5. Replacing the Batteries

## QUALIFIED SERVICE PERSONNEL ONLY

Please read all of the WARNINGS and CAUTIONS before attempting to service the batteries. Typical battery life is 3 to 5 years. Environmental factors do affect battery life. High temperatures, poor utility power, and frequent, short duration discharges have a negative impact on battery life.

**WARNING!** - This battery pack contains potentially hazardous voltages. Do not attempt to disassemble the battery pack beyond the battery replacement procedure. This battery pack contains no user serviceable parts. Repairs and battery replacement must be performed by QUALIFIED SERVICE PERSONNEL ONLY.

**CAUTION!** - Do not open or mutilate batteries. Released electrolyte is harmful to the skin and eyes and may be toxic.

**CAUTION!** - Do not dispose of batteries in a fire. The batteries may explode. The batteries in this battery pack are recyclable. Dispose of the batteries properly. The batteries contain lead and pose a hazard to the environment and human health if not disposed of properly. Refer to local codes for proper disposal requirements or return the battery to the supplier.

**CAUTION!** - The battery system can present a risk of electrical shock. These batteries produce sufficient current to burn wire or tools very rapidly, producing molten metal. Observe these precautions when replacing the batteries:

1. Remove watches, rings, or other metal objects.
2. Use hand tools with insulated handles.
3. Wear protective eye gear (goggles), rubber gloves and boots.
4. Do not lay tools or other metal parts on top of batteries.
5. Disconnect the charging source prior to connecting or disconnecting the battery terminals.
6. Determine if the battery is inadvertently grounded. If the battery is, remove the source of the grounding. Contact with any part of a grounded battery can result in an electrical shock. The likelihood of such shock will be reduced, if such grounds are removed during installation and maintenance.

**CAUTION!** - Replace batteries with the same number and type as originally installed in the battery pack. These batteries have pressure operated vents. These Battery Packs contain sealed non-spillable maintenance-free lead acid batteries.

Model #	BP24RTXL2U	BP48RTXL2U	BP72RTXL2U
Internal Battery Module Part #	BM0101	BM0102	BM0103

## BATTERY REPLACEMENT PROCEDURE (QUALIFIED SERVICE PERSONNEL ONLY)

### PLEASE READ THE CAUTIONS AND WARNINGS BEFORE ATTEMPTING TO REPLACE THE BATTERY MODULES

Hot-swappable batteries mean that the batteries can be replaced without powering down the whole UPS and battery pack system.

**NOTE:** If there is a power interruption while replacing the hot-swappable batteries, with the UPS on, the load will not be backed up.

1. Turn off all of the DC breakers on the rear panel of all of the Battery Packs.
2. Disconnect all of the external battery cables.
3. Remove the front panel retaining screws.
4. Remove the front panel and lay it on top of the Battery Pack.

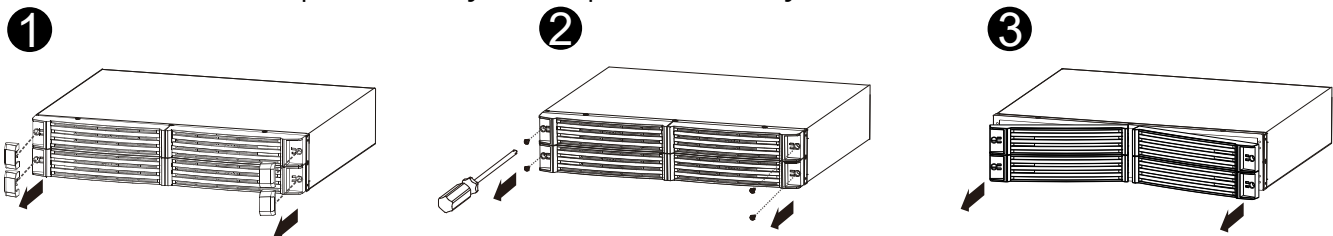

5. Remove the retaining screws for the battery retaining brackets.
6. Remove the battery retaining brackets.
7. Disconnect the battery connectors (red and black) from each of the battery modules.
8. Grasp one of the battery module's pull tabs and gently pull the battery module out of the Battery Pack and set on the floor.
9. Grasp the other battery module's pull tab and gently pull the battery module out of the Battery Pack and set on the floor.

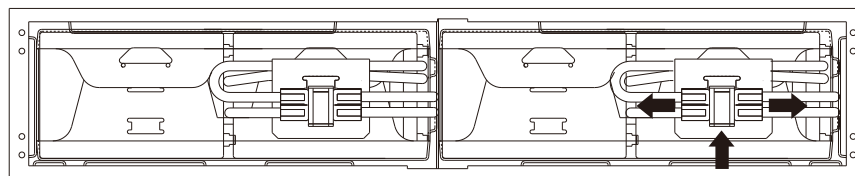

**NOTE:** Use Caution, the battery modules are heavy.

10. Slide the new battery modules into the Battery Pack.
11. Re-install the battery retaining brackets.
12. Re-install the retaining screws for the battery retaining brackets.
13. Verify proper polarity. Reconnect the battery connectors (red and black).

**NOTE:** Some sparking may occur this is normal.

14. Re-install the front panel on the Battery Pack.
15. Re-install the front panel retaining screws.
16. Reconnect all of the external battery cables.
17. Turn on all of the DC breakers on the rear panel of all of the Battery Packs.

18. Properly dispose of the old batteries at an appropriate recycling facility or return them to the supplier in the packing material for the new batteries.
19. The Battery Pack is ready for normal operation.

**NOTE:** If the UPS has a Weak/Bad Battery Alarm after replacing the battery modules, the user must initiate a self-test to clear the Weak/Bad Battery Alarm. To initiate a self-test see the section "**USER INVOKED BATTERY TEST**" in the UPS User's Manual.

## 6. Specifications

SYSTEM SPECIFICATION			
Model Number	BP24RTL2U	BP48RTL2U	BP72RTL2U
Installation Format	Rack/Tower Convertible		
BATTERY SYSTEM			
Battery Type	Sealed, Non-Spillable, Maintenance Free, Valve Regulated, Lead Acid		
Typical Recharge Time	24-hours from total discharge		
Typical Battery Life	3-5 years, depending on discharge cycles and ambient temp		
System Voltage	24VDC	48VDC	72VDC
Battery Module	BM0101	BM0102	BM0103
PHYSICAL			
Size - Net (LxWxH) (rackmount brackets installed)	430x440x88 (mm)	430x440x88 (mm)	581x440x88 (mm)
Weight - Net	27.2 (kg)	27.2 (kg)	37.8 (kg)
Size - Shipping (LxWxH)	631x578x208 (mm)	631x578x208 (mm)	782x578x208 (mm)
Weight - Shipping	30.3 (kg)	30.3 (kg)	41.1 (kg)
REGULATORY COMPLIANCE			
Safety and Approvals	cULus (UL1778 5th Edition & CSA 22.2 no. 107.3-14 / R: 2014), FCC Class A, CE certified, RoHS2 (EU Directive 2011/65/EU & 2015/863/EU)		



## 7. Warranty

Para Systems, Inc. (Para Systems) warrants this equipment, when properly applied and operated within specified conditions, against faulty materials or workmanship for a period of three years from the date of purchase. For equipment sites within the United States and Canada, this warranty covers depot repair or replacement of defective equipment at the discretion of Para Systems. Depot repair will be from the nearest authorized service center. The customer pays for shipping the product to Para Systems. Para Systems pays ground freight to ship the product back to the customer. Replacement parts and warranty labor will be borne by Para Systems. For equipment located outside of the United States and Canada, Para Systems only covers faulty parts. Para Systems products that are depot repaired or replaced pursuant to this warranty shall only be warranted for the unexpired portion of the warranty applying to the original product. This warranty applies only to the original purchaser who must have properly registered the product within 10 days of purchase.

The warranty shall be void if (a) the equipment is damaged by the customer, is improperly used, is subjected to an adverse operating environment, or is operated outside the limits of its electrical specifications; (b) the equipment is repaired or modified by anyone other than Para Systems or Para Systems approved personnel; or (c) has been used in a manner contrary to the product's User's Manual or other written instructions.

Any technical advice furnished before or after delivery in regard to use or application of Para Systems' equipment is furnished without charge and on the basis that it represents Para Systems' best judgment under the circumstances, but it is used at the recipient's sole risk.

EXCEPT AS PROVIDED HEREIN, PARA SYSTEMS MAKES NO WARRANTIES, EXPRESSED OR IMPLIED, INCLUDING WARRANTIES OF MERCHANTABILITY AND FITNESS FOR A PARTICULAR PURPOSE. Some states do not permit limitation of implied warranties; therefore, the aforesaid limitation(s) may not apply to the purchaser.

EXCEPT AS PROVIDED ABOVE, IN NO EVENT WILL PARA SYSTEMS BE LIABLE FOR DIRECT, INDIRECT, SPECIAL, INCIDENTAL, OR CONSEQUENTIAL DAMAGES ARISING OUT OF THE USE OF THIS PRODUCT, EVEN IF ADVISED OF THE POSSIBILITY OF SUCH DAMAGE. Specifically, Para Systems is not liable for any costs, such as; labor for on-site installation, on-site maintenance or on-site service, lost profits or revenue, loss of equipment, loss of use of equipment, loss of software, loss of data, cost of substitutes, claims by third parties, or otherwise. The sole and exclusive remedy for breach of any warranty, expressed or implied, concerning Para Systems' products and the only obligation of Para Systems hereunder, shall be depot repair or replacement of defective equipment, components, or parts; or, at Para Systems' option, refund of the purchase price or substitution with an equivalent replacement product. This warranty gives you specific legal rights and you may also have other rights which vary from state to state.

No employee, salesman, or agent of Para Systems is authorized to add to or vary the terms of this warranty.

Please go to our website at [www.minutemanups.com/warranty/](http://www.minutemanups.com/warranty/) to fill out the Warranty Registration.

## **Additional Notices:**

**NOTICE:** This product complies with the rules for Class A device, pursuant to Part 15 of the FCC rules for radio noise emissions from a digital apparatus.

These limits are designed to provide reasonable protection against such interference in a residential installation.

This equipment generates and uses radio frequency and if not installed and used properly, in strict accordance with the manufacturer's instructions, may cause interference to radio and television reception. If this device does cause interference to radio or television reception, which can be determined by turning the equipment off and on, the user is encouraged to try to correct the interference by one or more of the following measures:

- Reorient the receiving antenna.
- Relocate the computer with respect to the receiver.
- Move the computer away from the receiver.
- Plug the computer into a different outlet so that the computer and receiver are on different branch circuits.
- Shielded communications interface cables must be used with this product.

## **Life Support Policy**

Para Systems does not support the use of any of its products in life support applications where the failure or malfunction of the product can be reasonably expected to cause failure to life support devices or to significantly affect their safety or effectiveness. Furthermore, Para Systems does not recommend the use of any of its products in direct patient care.



RoHS2  
FCC Class A  
cULus (UL1778 5<sup>th</sup> Edition)  
CE Compliant

Para Systems, Inc.  
1455 LeMay Drive  
Carrollton, TX 75007  
800.238.7272

[www.minutemanups.com](http://www.minutemanups.com)

## **© 2024 PARA SYSTEMS, INC.**

Minuteman Power Technologies, Encompass and SentryHD are owned by Para Systems, Inc. All other trademarks are property of their irrespective owners.

## A1. Declaration of Conformity

Application of Council Directive(s): 2014/30/EU

Standard(s) to which Conformity is declared: EN62040-2, IEC61000-2-2 IEC61000-4-2, IEC61000-4-3, IEC61000-4-4, IEC61000-4-5, IEC61000-4-6, IEC61000-4-8, UL1778, CSA 22.2 no. 107.3-14, FCC Class A

Manufacturer's Name: Para Systems, Inc. (MINUTEMAN UPS)

Manufacturer's Address: 1455 LeMay Drive Carrollton, Texas 75007 USA

Type of Equipment: Uninterruptible Power Supplies (UPS)

Model No: BP24RTXL2U (Y), BP48RTXL2U (Y), BP72RTXL2U (Y)

Year of Manufacture: Beginning January 2025

I hereby declare that the equipment specified above conforms to the above Directive(s).

Kevin Canole  
(Name)

Director of Business Development  
(Position)

Place: Carrollton, Texas, USA

Date: September 12, 2024

